



Midi series are adapted for water and compressed air applications. The wide range of plugs allows many combinations for the end-users.

- Designed for transmission of water and fluids
- High flow capabilities
- Maximum energy efficiency

own Profile

**KA** Single Shut-Off

**Working Pressure\*:**  
up to 20 bar

**Material:**

- Coupling: Nickel plated brass
- Plug: Nickel plated brass
- Seals: NBR

**Working Temperature:**  
-20°C up to +100°C (NBR)

**Flow Rate Air:**  
2.200 NI/min.  
inlet pressure 6 bar, pressure drop 0.6 bar

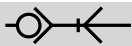

Single Shut-Off

## 0172 Coupler with valve, Female BSPP Thread

Nickel-plated brass, NBR

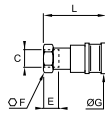

DN	C		E	F	G	L
12	G3/8	<b>0172 12 17</b>	16	27	29	56
12	G1/2	<b>0172 12 21</b>	16	27	29	56

Midi Series: single shut-off = 2200NI/min



Straight-Through

## 2272 Coupler without valve, Female BSPP Thread

Nickel-plated brass, NBR

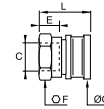

DN	C		E	F	G	L
12	G1/2	<b>2272 12 21</b>	10	24	29	33
12	G3/4	<b>2272 12 27</b>	10	30	29	34.5
12	G1	<b>2272 12 34</b>	10	36	29	34.5

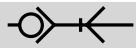

Single Shut-Off

## 2511 Coupler with valve, with Barb Connection for Hose

Nickel-plated brass, NBR

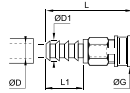

DN	ØD	ØD1		G	L	L1
12	12	13.5	<a href="#">2511 12 12</a>	29	75	32
12	15	16.5	<a href="#">2511 12 15</a>	29	75	32
12	19	20.5	<a href="#">2511 12 19</a>	29	81	38

Midi Series: single shut-off = 2200NI/min

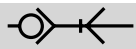

Straight-Through

## 2297 Coupler without valve, with Barb Connection for Hose

Nickel-plated brass, NBR

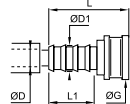

DN	ØD	ØD1		G	L	L1
12	12	13.5	<a href="#">2297 12 12</a>	29	51	27
12	15	16.5	<a href="#">2297 12 15</a>	29	51	27
12	19	20.5	<a href="#">2297 12 19</a>	29	57	33

## 2294 Plug without valve, Male BSPP Thread

Nickel-plated brass

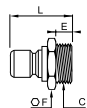

DN	C		E	F	L
12	G3/8	<a href="#">2294 12 17</a>	6	22	31.5
12	G1/2	<a href="#">2294 12 21</a>	9.5	22	37
12	G3/4	<a href="#">2294 12 27</a>	13.5	27	41
12	G1	<a href="#">2294 12 34</a>	10.5	34	36

Probe without Shut-off

## 0196 Plug without valve, Female BSPP Thread

Nickel-plated brass

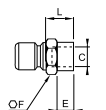

DN	C		E	F	L
12	G1/4	<a href="#">0196 12 13</a>	12	17	16
12	G3/8	<a href="#">0196 12 17</a>	12	21	15
12	G1/2	<a href="#">0196 12 21</a>	14	26	17

Probe without Shut-off



Straight-Through

## 2296 Plug without valve, Female BSPP Thread

Nickel-plated brass

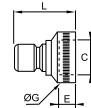

DN	C		E	G	L
12	G1/2	<a href="#">2296 12 21</a>	11	24	31.5
12	G3/4	<a href="#">2296 12 27</a>	11	30	38
12	G1	<a href="#">2296 12 34</a>	11	36	36.5

Probe without Shut-off

## 0195 Plug without valve, with Barb Connection for Flexible Tubing

Nickel-plated brass

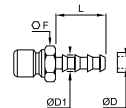

DN	ØD	ØD1		F	L
12	7	9	<a href="#">0195 07 00</a>	17	29.5
12	10	12.2	<a href="#">0195 10 00</a>	17	29.5
12	13	15.2	<a href="#">0195 13 00</a>	17	29.5
12	16	18.5	<a href="#">0195 16 00</a>	21	36.5

Probe without Shut-off

## 2295 Plug without valve, with Barb Connection for Flexible Hose

Nickel-plated brass

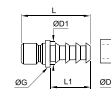

DN	ØD	ØD1		G	L	L1
12	12	13.5	<a href="#">2295 12 12</a>	17	48	27
12	15	16.5	<a href="#">2295 12 15</a>	18	48	27
12	19	20.5	<a href="#">2295 12 19</a>	24	57	33

Probe without Shut-off

## 2293 Y Coupler, Straight Through

Nickel-plated brass, NBR

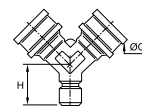

DN		G	H
12	<a href="#">2293 12 00</a>	29	27

Probe without Shut-off

Midi Series: straight-through = 2200 NI/min

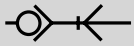

Straight-Through

## 2270 Coupler without valve, with Tap, Male BSPP Thread

Nickel-plated brass, NBR

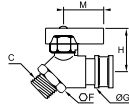

DN	C		F	G	H
12	G1/2	<b>2270 21 00</b>	28	29	40.5

Flow = 2200 NI/min

## 2292 Universal Coupler Adaptor

Nickel-plated brass, NBR

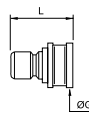

DN			G	L
12		<b>2292 12 00</b>	29	40.5

Without shut-off  
This adaptor provides interchangeability with numerous components (especially watering accessories).

## 2398 Universal Plug Adaptor

Nickel-plated brass, NBR

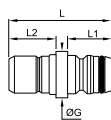

DN			G	L	L1	L2
12		<b>2398 12 01</b>	20	43	19	18.5

This adaptor provides interchangeability with numerous components (especially watering accessories).

## 2299 Water Pistol

Zamak, nickel-plated brass, NBR

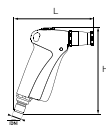

DN			H	L
12		<b>2299 12 01</b>	140	126
12		<b>2299 12 20</b>		77.4

This pistol allows independent control of:  
- the flow rate (trigger)  
- type of jet (adjustable to a fine mist) by the adjustable nozzle