

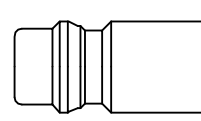

This coupling system has been developed specifically for the area of air breathing apparatus. Coupling system with single-hand operation. High Flow valve for optimum flow and low pressure drop. Additional safety locking system. This safety lock prevents unintentional disconnection. To disconnect, the plug must first be pushed further into the coupling before it can be unlocked. Tested according to DIN EN 14593.

- Available on request:
  - with additional end connections
  - other seals for different temperature ranges and fluids



**Dust Protections** (P. 357)  
for Coupling Part.-No. SK23S  
for Plug Part.-No. SK12S



**Working Pressure\*:**  
up to 35 bar

**Material:**

- **Coupling:** Nickel plated brass
- **Plug:** Nickel plated brass or AISI 303
- **Seals:** NBR or FKM

**Working Temperature:**

-20°C up to +100°C (NBR)

**Flow Rate Air:**

1.700 l/min.

inlet pressure 6 bar, pressure drop 0.5 bar

\* maximum static working pressure with design factor 4 to 1.



## Breathing Air

### 96KSAK Coupler with valve, Male Thread

Nickel-plated brass, NBR

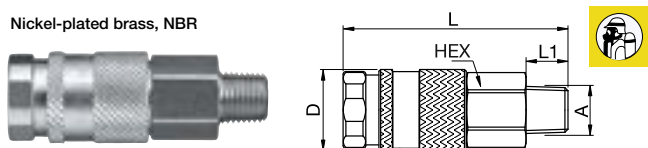

A		HEX	L	L1	D
R1/4	96KSAK13BPN	19	65	12	23
R3/8	96KSAK17BPN	19	64	12	23
R1/2	96KSAK21BPN	22	66	17	23



## Breathing Air

### 96KSTF Coupler with valve, Hose Barb

Nickel-plated brass, NBR

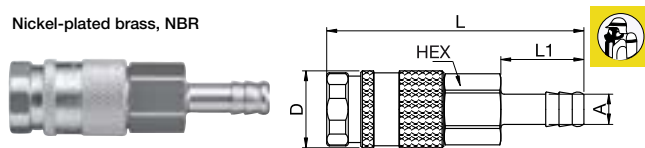

A		HEX	L	L1	D
6	96KSTF06BPN	19	78	25	23
9	96KSTF09BPN	19	78	25	23
10	96KSTF10BPN	19	78	25	23
13	96KSTF13BPN	19	78	25	23

### 96KSIW Coupler with valve, Female Thread

Nickel-plated brass, NBR

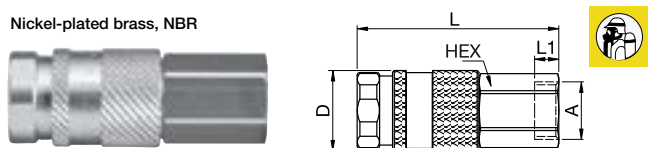

A		HEX	L	L1	D
G1/4	96KSIW13BPN	19	60	10	23
G3/8	96KSIW17BPN	19	59	9	23
G1/2	96KSIW21BPN	24	62	10	23



## Breathing Air

### 96SSA Plug without valve, Male Thread

Nickel-plated brass or stainless steel

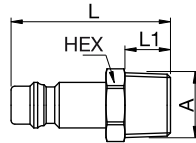

A		HEX	L	L1	Version
R1/4	<b>96SSAK13MXN</b>	14	42	12	Nickel-plated brass
R3/8	<b>96SSAK17MXN</b>	17	42	12	Nickel-plated brass
G3/8	<b>96SSAW17RXX</b>	19	38	9	AISI 303

### 96SSIW Plug without valve, Female Thread

Nickel-plated brass

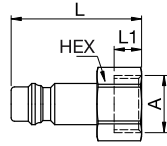

A		HEX	L	L1
G1/4	<b>96SSIW13MXN</b>	17	38	10
G3/8	<b>96SSIW17MXN</b>	19	38	10

### 96SSTF Plug without valve, Hose Barb

Nickel-plated brass

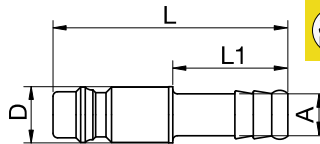

A		L	L1	D
6	<b>96SSTF06MXN</b>	51	25	12
9	<b>96SSTF09MXN</b>	51	25	12
10	<b>96SSTF10MXN</b>	54	25	14