

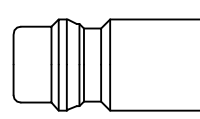

This coupling system has been developed specifically for the area of air breathing apparatus. Coupling system with single-hand operation. High Flow valve for optimum flow and low pressure drop. Additional safety locking system. This safety lock prevents unintentional disconnection. To disconnect, the plug must first be pushed further into the coupling before it can be unlocked. Profile cannot be interconnected with the 96KS series. Tested according DIN EN 14593.

- Available on request:
 - with additional end connections
 - other seals for different temperature ranges and fluids



Dust Protections (P. 357)
for Coupling Part.-No. SK23S



Working Pressure*:
up to 35 bar

Material:

- **Coupling:** Nickel plated brass / AISI 303 or nickel plated brass
- **Plug:** Nickel plated brass
- **Seals:** NBR

Working Temperature:

-20°C up to +100°C (NBR)

Flow Rate Air:

1.700 l/min.

inlet pressure 6 bar, pressure drop 0.5 bar

* maximum static working pressure with design factor 4 to 1.



Breathing Air

95KSAK Coupler with valve, Male Thread

Nickel-plated brass or stainless steel, NBR

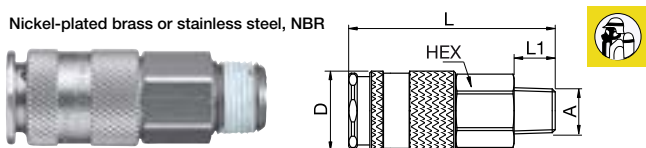

A	Version	HEX	L	L1	D	Version
R1/4	95KSAK13BPN	19	61	12	23	Nickel-plated brass
R1/4	95KSAK13RPN	19	61	12	23	Nickel-plated brass / AISI 303
R3/8	95KSAK17BPN	19	60	12	23	Nickel-plated brass
R3/8	95KSAK17RPN	19	60	12	23	Nickel-plated brass / AISI 303
R1/2	95KSAK21BPN	22	61	17	23	Nickel-plated brass
R1/2	95KSAK21RPN	22	61	17	23	Nickel-plated brass / AISI 303



Breathing Air

95KSIW Coupler with valve, Female Thread

Nickel-plated brass or stainless steel, NBR

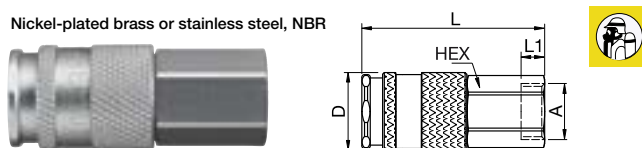

A	Version	HEX	L	L1	D	Version
G1/4	95KSIW13BPN	19	56	10	23	Nickel-plated brass
G1/4	95KSIW13RPN	19	56	10	23	Nickel-plated brass / AISI 303
G3/8	95KSIW17BPN	19	55	9	23	Nickel-plated brass
G3/8	95KSIW17RPN	19	55	9	23	Nickel-plated brass / AISI 303
G1/2	95KSIW21BPN	24	58	12	23	Nickel-plated brass
G1/2	95KSIW21RPN	24	58	12	23	Nickel-plated brass / AISI 303



Breathing Air

95KSTF Coupler with valve, Hose Barb

Nickel-plated brass or stainless steel, NBR

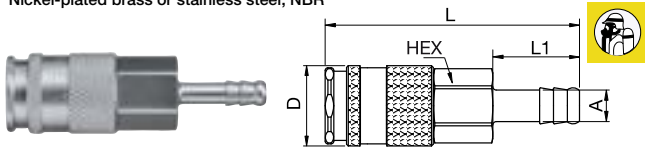

A		HEX	L	L1	D	Version
6	95KSTF06BPN	19	74	25	23	Nickel-plated brass
8	95KSTF08BPN	19	74	25	23	Nickel-plated brass
9	95KSTF09BPN	19	74	25	23	Nickel-plated brass
9	95KSTF09RPN	19	74	25	23	Stainless Steel
10	95KSTF10BPN	19	74	25	23	Nickel-plated brass
10	95KSTF10RPN	19	74	25	23	Stainless Steel
13	95KSTF13BPN	19	74	25	23	Nickel-plated brass

95SSAK Plug without valve, Male Thread

Nickel-plated brass

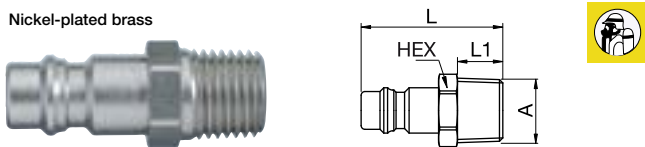

A		HEX	L	L1
R1/4	95SSAK13MXN	14	37.5	12
R3/8	95SSAK17MXN	17	37.5	12

95SSIW Plug without valve, Female Thread

Nickel-plated brass

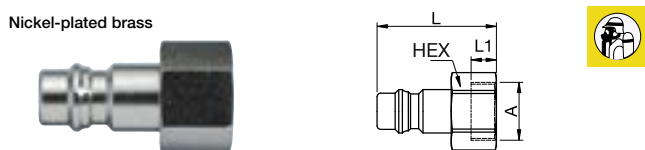

A		HEX	L	L1
G1/4	95SSIW13MXN	17	33	9
G3/8	95SSIW17MXN	19	33	9

95SSTF Plug without valve, Hose Barb

Nickel-plated brass

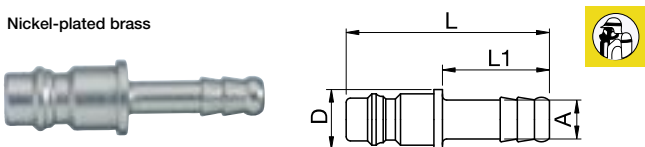

A		L	L1	D
6	95SSTF06MXN	47.5	25	14
9	95SSTF09MXN	47.5	25	14
10	95SSTF10MXN	47.5	25	14