



Euro Profile



Mini industrial coupling with internationally used profile. Frequent use in medical technology and chemistry/pharmacy. Coupling system with single-hand operation. Wide range of applications with different media.

- Available on request:
  - with additional end connections
  - other seals for different temperature ranges and fluids

## KA Single Shut-Off

**Working Pressure\*:**  
up to 35 bar

**Material:**

- Coupling: Brass
- Plug: Brass
- Seals: NBR

**Working Temperature:**  
-20°C up to +100°C (NBR)

**Flow Rate Air:**  
165 l/min.  
inlet pressure 6 bar, pressure drop 0.5 bar

**Flow Rate Air:**  
1.5 l/min.  
pressure drop 0.5 bar

## KB Double Shut-Off

**Working Pressure\*:**  
up to 35 bar

**Material:**

- Coupling: Brass
- Plug: Brass
- Seals: NBR

**Working Temperature:**  
-20°C up to +100°C (NBR)

**Flow Rate Air:**  
130 l/min.  
inlet pressure 6 bar, pressure drop 0.5 bar

**Flow Rate Air:**  
1.2 l/min.  
pressure drop 0.5 bar

\* maximum static working pressure with design factor 4 to 1.

### Single Shut-Off

### Single Shut-Off

## 20KAA Coupler with valve, Male Thread

Brass, NBR

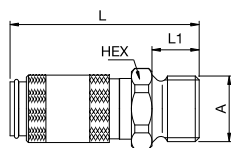

A		HEX	L	L1	D	Version
M5	20KAAM05MPX	9	26	5	10	Brass
M5	20KAAM05MPN	9	26	5	10	Nickel-plated brass
G1/8	20KAAW10MPX	11	28	7	10	Brass
G1/8	20KAAW10MPN	11	28	7	10	Nickel-plated brass

## 20KAI Coupler with valve, Female Thread

Brass, NBR

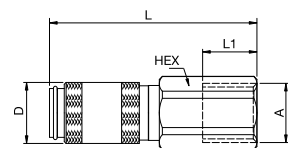

A		HEX	L	L1	D	Version
M5	20KAIM05MPX	9	26	5	10	Brass
M5	20KAIM05MPN	9	26	5	10	Nickel-plated brass
G1/8	20KAIW10MPX	12	28	7	10	Brass
G1/8	20KAIW10MPN	12	28	7	10	Nickel-plated brass

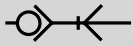

Single Shut-Off

## 20KATF Coupler with valve, Hose Barb

Brass, NBR

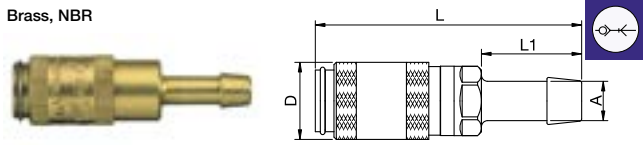

A		L	L1	D	Version
3	<b>20KATF03MPX</b>	35	13	10	Brass
3	<b>20KATF03MPN</b>	35	13	10	Nickel-plated brass
4	<b>20KATF04MPX</b>	35	13	10	Brass
4	<b>20KATF04MPN</b>	35	13	10	Nickel-plated brass
5	<b>20KATF05MPX</b>	35	13	10	Brass
5	<b>20KATF05MPN</b>	35	13	10	Nickel-plated brass

## 20KAKO Coupler with valve, with Plastic Hose Connection

Brass, NBR

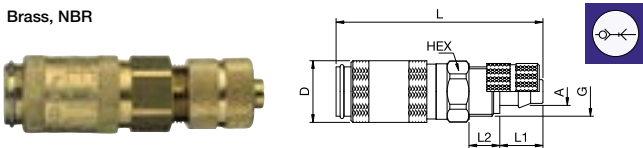

A		HEX	G	L	L1	L2	D	Version
3 x 4	<b>20KAKO04MPX</b>	9	M7x0.5	34	7	5	10	Brass
3 x 4	<b>20KAKO04MPN</b>	9	M7x0.5	34	7	5	10	Nickel-plated brass
3 x 5	<b>20KAKO05MPX</b>	9	M7x0.5	34	7	5	10	Brass
3 x 5	<b>20KAKO05MPN</b>	9	M7x0.5	34	7	5	10	Nickel-plated brass
4 x 6	<b>20KAKO06MPX</b>	9	M8x0.5	34	7	5	10	Brass
4 x 6	<b>20KAKO06MPN</b>	9	M8x0.5	34	7	5	10	Nickel-plated brass

## 20KAKS Coupler with valve, Panel Mount with Plastic Hose Connection

Brass, NBR

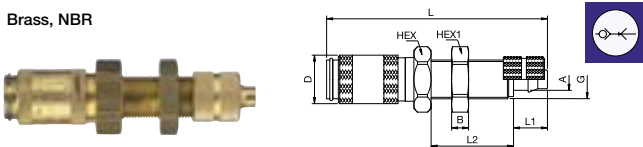

A		HEX	HEX1	B	G	L	L1	L2	D	Version
3 x 4	<b>20KAKS04MPX</b>	12	11	3	M7x0.5	45	7	17	10	Brass
3 x 4	<b>20KAKS04MPN</b>	12	11	3	M7x0.5	45	7	17	10	Nickel-plated brass
3 x 5	<b>20KAKS05MPX</b>	12	11	3	M7x0.5	45	7	17	10	Brass
3 x 5	<b>20KAKS05MPN</b>	12	11	3	M7x0.5	45	7	17	10	Nickel-plated brass
4 x 6	<b>20KAKS06MPX</b>	12	11	3	M8x0.5	45	7	17	10	Brass
4 x 6	<b>20KAKS06MPN</b>	12	11	3	M8x0.5	45	7	17	10	Nickel-plated brass

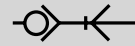

Single Shut-Off

## 20KATS Coupler with valve, Panel Mount with Hose Barb

Brass, NBR

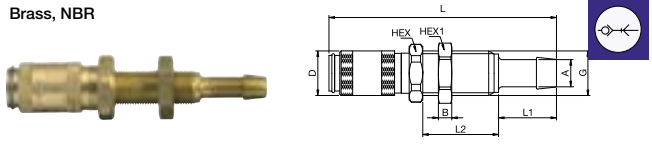

A		HEX	HEX1	B	G	L	L1	L2	D	Version
3	<b>20KATS03MPX</b>	12	11	3	M7x0.5	51	13	17	10	Brass
3	<b>20KATS03MPN</b>	12	11	3	M7x0.5	51	13	17	10	Nickel-plated brass
4	<b>20KATS04MPX</b>	12	11	3	M7x0.5	51	13	17	10	Brass
4	<b>20KATS04MPN</b>	12	11	3	M7x0.5	51	13	17	10	Nickel-plated brass

## 20KARP Coupler with valve, Push-In

Nickel-plated brass, NBR

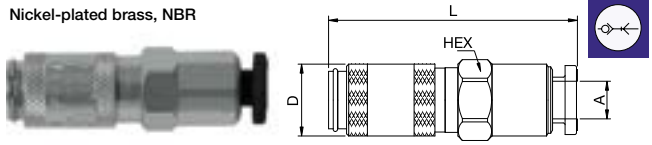

A		HEX	L	D
4	<b>20KARP04MPN</b>	10	35	10

## 20SFA Plug without valve, Male Thread

Brass

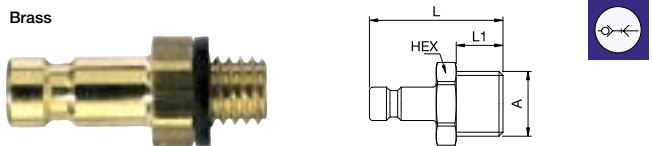

A		HEX	L	L1	Version
M5	<b>20SFAM05MXX</b>	7	18	5	Brass
M5	<b>20SFAM05MXN</b>	<b>9087 20 19</b>	7	18	Nickel-plated brass
G1/8	<b>20SFAW10MXX</b>	11	20	7	Brass
G1/8	<b>20SFAW10MXN</b>	<b>9087 20 10</b>	11	20	Nickel-plated brass

## 20SFI Plug without valve, Female Thread

Brass

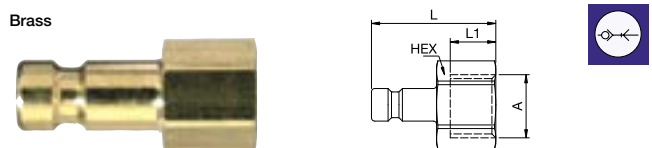

A		HEX	L	L1	Version
M5	<b>20SFIM05MXX</b>	7	17	5	Brass
M5	<b>20SFIM05MXN</b>	<b>9086 20 19</b>	7	17	Nickel-plated brass
G1/8	<b>20SFIW10MXX</b>	12	19	7	Brass
G1/8	<b>20SFIW10MXN</b>	<b>9086 20 10</b>	12	19	Nickel-plated brass

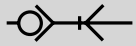

Single Shut-Off

## 20SFTF Plug without valve, Hose Barb

Brass

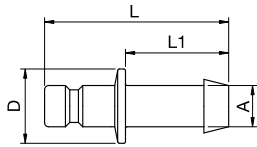

A			L	L1	D	Version
3			24	13	7	Brass
3			24	13	7	Nickel-plated brass
4			24	13	7	Brass
4			24	13	7	Nickel-plated brass
5			22	13	9	Brass
5			22	13	9	Nickel-plated brass

## 20SFK0 Plug without valve, with Plastic Hose Connection

Brass

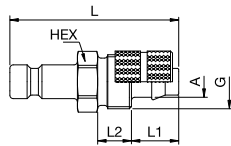

A		HEX	G	L	L1	L2	Version
3 x 4		7	M7x0.5	25	7	5	Brass
3 x 4		7	M7x0.5	25	7	5	Nickel-plated brass
3 x 5		7	M7x0.5	25	7	5	Brass
3 x 5		7	M7x0.5	25	7	5	Nickel-plated brass
4 x 6		8	M8x0.5	25	7	5	Brass
4 x 6		8	M8x0.5	25	7	5	Nickel-plated brass

## 20SFKS Plug without valve, Panel Mount with Plastic Hose Connection

Brass

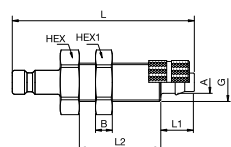

A		HEX	HEX1	B	G	L	L1	L2	Version
3 x 4		11	11	3	M7x0.5	38	7	17	Brass
3 x 4		11	11	3	M7x0.5	38	7	17	Nickel-plated brass
3 x 5		11	11	3	M7x0.5	38	7	17	Brass
3 x 5		11	11	3	M7x0.5	38	7	17	Nickel-plated brass
4 x 6		12	12	3	M8x0.5	38	7	17	Brass
4 x 6		12	12	3	M8x0.5	38	7	17	Nickel-plated brass

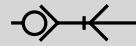

Single Shut-Off

## 20SFTS Plug without valve, Panel Mount with Hose Barb

Brass

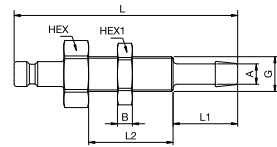

A			HEX	HEX1	B	G	L	L1	L2	Version
3			12	11	3.5	M7x0.5	45	13	18	Brass
3			12	11	3.5	M7x0.5	45	13	18	Nickel-plated brass
4			12	11	3	M7x0.5	45	13	17	Brass
4			12	11	3	M7x0.5	45	13	17	Nickel-plated brass

## 20SFRP Plug without valve, Push-In

Nickel-plated brass, NBR

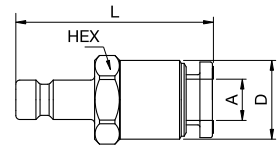

A		HEX	L	D
4		10	35	10



Double Shut-off

## 20KBA Coupler with valve, Male Thread

Brass, NBR

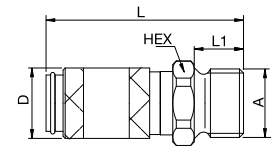

A			HEX	L	L1	D	Version
M5			9	26	5	10	Brass
M5			9	26	5	10	Nickel-plated brass
G1/8			11	28	7	10	Brass
G1/8			11	28	7	10	Nickel-plated brass

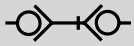

Double Shut-off

## 20KBI Coupler with valve, Female Thread

Brass, NBR

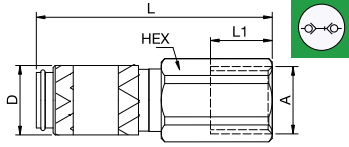

A	Version	HEX	L	L1	D	Version
M5	<b>20KBIM05MPX</b>	9	26	5	10	Brass
M5	<b>20KBIM05MPN</b> 9214 20 19	9	26	5	10	Nickel-plated brass
G1/8	<b>20KBIW10MPX</b>	12	28	7	10	Brass
G1/8	<b>20KBIW10MPN</b> 9214 20 10	12	28	7	10	Nickel-plated brass

## 20KBT Coupler with valve, Hose Barb

Brass, NBR

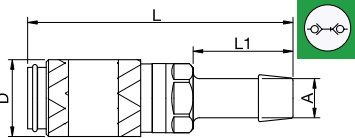

A	Version	L	L1	D	Version
3	<b>20KBTf03MPX</b>	35	13	10	Brass
3	<b>20KBTf03MPN</b>	35	13	10	Nickel-plated brass
4	<b>20KBTf04MPX</b>	35	13	10	Brass
4	<b>20KBTf04MPN</b>	35	13	10	Nickel-plated brass
5	<b>20KBTf05MPX</b>	35	13	10	Brass
5	<b>20KBTf05MPN</b>	35	13	10	Nickel-plated brass

## 20KBKO Coupler with valve, with Plastic Hose Connection

Brass, NBR

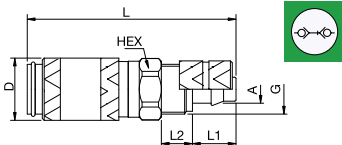

A	Version	HEX	G	L	L1	L2	D	Version
3 x 4	<b>20KBK004MPX</b>	9	M7x0.5	34	7	5	10	Brass
3 x 4	<b>20KBK004MPN</b>	9	M7x0.5	34	7	5	10	Nickel-plated brass
3 x 5	<b>20KBK005MPX</b>	9	M7x0.5	34	7	5	10	Brass
3 x 5	<b>20KBK005MPN</b>	9	M7x0.5	34	7	5	10	Nickel-plated brass
4 x 6	<b>20KBK006MPX</b>	9	M8x0.5	34	7	5	10	Brass
4 x 6	<b>20KBK006MPN</b>	9	M8x0.5	34	7	5	10	Nickel-plated brass

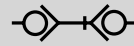

Double Shut-off

## 20KBKS Coupler with valve, Panel Mount with Plastic Hose Connection

Brass, NBR

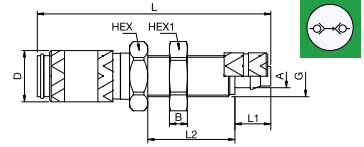

A	Version	HEX	HEX1	B	G	L	L1	L2	D	Version
3 x 4	<b>20KBKS04MPX</b>	12	11	3	M7x0.5	45	7	17	10	Brass
3 x 4	<b>20KBKS04MPN</b>	12	11	3	M7x0.5	45	7	17	10	Nickel-plated brass
3 x 5	<b>20KBKS05MPX</b>	12	11	3	M7x0.5	45	7	17	10	Brass
3 x 5	<b>20KBKS05MPN</b>	12	11	3	M7x0.5	45	7	17	10	Nickel-plated brass
4 x 6	<b>20KBKS06MPX</b>	12	12	3.5	M8x0.5	45	7	17	10	Brass
4 x 6	<b>20KBKS06MPN</b>	12	12	3.5	M8x0.5	45	7	17	10	Nickel-plated brass

## 20KBTS Coupler with valve, Panel Mount with Hose Barb

Brass, NBR

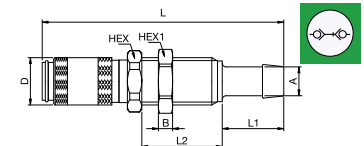

A	Version	HEX	HEX1	B	G	L	L1	L2	D	Version
3	<b>20KBTS03MPX</b>	12	11	3	M7x0.5	51	13	17	10	Brass
3	<b>20KBTS03MPN</b> 9226 20 03	12	11	3	M7x0.5	51	13	17	10	Nickel-plated brass
4	<b>20KBTS04MPX</b>	12	11	3	M7x0.5	51	13	17	10	Brass
4	<b>20KBTS04MPN</b> 9226 20 04	12	11	3	M7x0.5	51	13	17	10	Nickel-plated brass

## 20KBRP Coupler with valve, Push-In

Nickel-plated brass, NBR

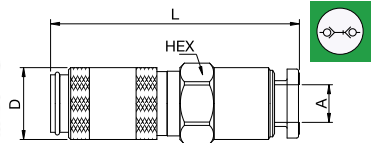

A	Version	HEX	L	D
4	<b>20KBRP04MPN</b>	10	35	10

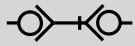

Double Shut-off

## 20SBA Plug with valve, Male Thread

Brass, NBR

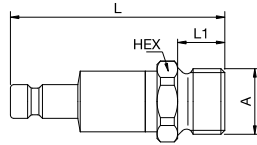

A			HEX	L	L1	Version
M5			9	28	5	Brass
M5			9	28	5	Nickel-plated brass
G1/8			11	30	7	Brass
G1/8			11	30	7	Nickel-plated brass

## 20SBI Plug with valve, Female Thread

Brass, NBR

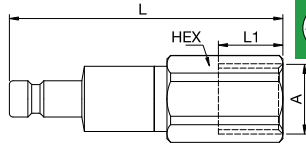

A			HEX	L	L1	Version
M5			9	26	5	Brass
M5			9	26	5	Nickel-plated brass
G1/8			12	30	7	Brass
G1/8			12	30	7	Nickel-plated brass

## 20SBTF Plug with valve, Hose Barb

Brass, NBR

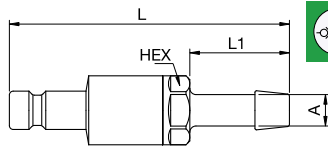

A			HEX	L	L1	Version
3			8	36	13	Brass
3			8	36	13	Nickel-plated brass
4			8	36	13	Brass
4			8	36	13	Nickel-plated brass
5			8	36	13	Brass
5			8	36	13	Nickel-plated brass

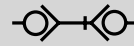

Double Shut-off

## 20SBKO Plug with valve, with Plastic Hose Connection

Brass, NBR

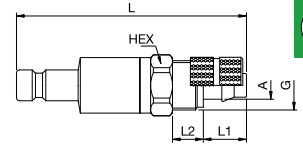

A			HEX	G	L	L1	L2	Version
3 x 4			9	M7x0.5	30.5	7	5	Brass
3 x 4			9	M7x0.5	30.5	7	5	Nickel-plated brass
3 x 5			9	M7x0.5	30.5	7	5	Brass
3 x 5			9	M7x0.5	30.5	7	5	Nickel-plated brass
4 x 6			9	M8x0.5	30.5	7	5	Brass
4 x 6			9	M8x0.5	30.5	7	5	Nickel-plated brass

## 20SBKS Plug with valve, Panel Mount with Plastic Hose Connection

Brass, NBR

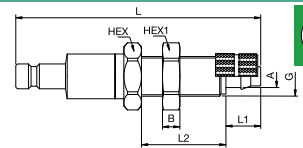

A			HEX	HEX1	B	G	L	L1	L2	D	Version
3 x 4			12	11	3	M7x0.5	46.5	7	17	10	Brass
3 x 4			12	11	3	M7x0.5	46.5	7	17	10	Nickel-plated brass
3 x 5			12	11	3	M7x0.5	46.5	7	17	10	Brass
3 x 5			12	11	3	M7x0.5	46.5	7	17	10	Nickel-plated brass
4 x 6			12	12	3.5	M8x0.5	46.5	7	17	10	Brass
4 x 6			12	12	3.5	M8x0.5	46.5	7	17	10	Nickel-plated brass

## 20SBTS Plug with valve, Panel Mount with Hose Barb

Brass, NBR

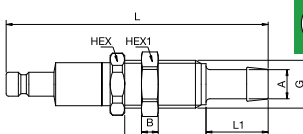
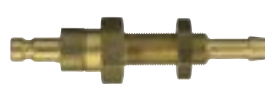

A			HEX	HEX1	B	G	L	L1	L2	Version
3			12	11	3	M7x0.5	52.5	13	17	Brass
3			12	11	3	M7x0.5	52.5	13	17	Nickel-plated brass
4			12	11	3	M7x0.5	52.5	13	17	Brass
4			12	11	3	M7x0.5	52.5	13	17	Nickel-plated brass

## 20SBRP Plug with valve, Push-In

Nickel-plated brass, NBR

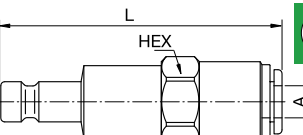

A			HEX	L
3 x 4			10	34