

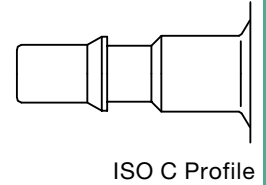

Robust industrial coupling according to ISO 6150 C. Coupling system with single-hand operation. High Flow valve for optimum flow and low pressure drop.
The steel sleeve counters oscillating forces. System has limited use for liquids (steel sleeve/zinc die cast valve). The high insertion depth guarantees by an optimised plug guidance.

- Available on request:
 - with additional end connections
 - other seals for different temperature ranges and fluids



Dust Protections (P. 357)
for Coupling Part.-No. SK23S



Working Pressure*:
up to 35 bar

Material:

- Coupling: Nickel plated brass / steel
- Plug: Nickel plated steel
- Seals: NBR

Working Temperature:
-20°C up to +100°C (NBR)

Flow Rate Air:
970 l/min.
inlet pressure 6 bar, pressure drop 0.5 bar

Flow Rate Water:
12.7 l/min.
pressure drop 0.5 bar

* maximum static working pressure with design factor 4 to 1.



18KAAK Coupler with valve, Male Thread

Nickel-plated brass/steel, NBR

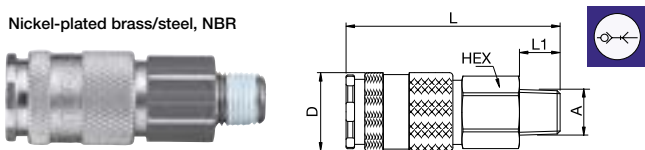

A		HEX	L	L1	D
R1/4	18KAAK13MPN	19	63	12	23
R3/8	18KAAK17MPN	19	62	12	23
R1/2	18KAAK21MPN	22	63	17	23

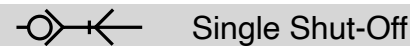

18KATF Coupler with valve, Hose Barb

Nickel-plated brass/steel, NBR

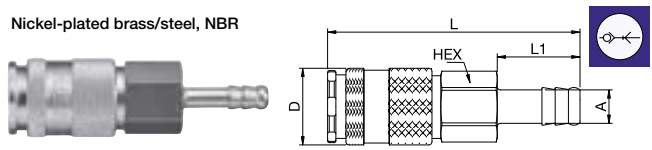

A			HEX	L	L1	D
6	18KATF06MPN	9123 18 06	19	76	25	23
8	18KATF08MPN	9123 18 08	19	76	25	23
10	18KATF10MPN	9123 18 10	19	76	25	23
13	18KATF13MPN		19	76	25	23

18KAIW Coupler with valve, Female Thread

Nickel-plated brass/steel, NBR

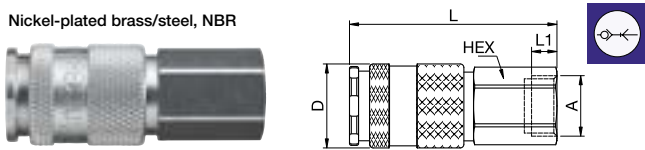

A			HEX	L	L1	D
G1/4	18KAIW13MPN	9114 18 13	19	58	9	23
G3/8	18KAIW17MPN	9114 18 17	19	57	9	23
G1/2	18KAIW21MPN		24	60	12	23