



Safety coupling with a self-venting system. Self-venting takes place during disconnection – no risk of pressurised hoses being tossed around. When the sleeve is pulled back, the plug is released yet remains locked in. The coupling valve closes and the air is vented from the air line at the same time. Only then, by operating the sleeve again, can uncoupling take place safely. The system fulfils the requirements of ISO 4414 – increased safety standards in the work place. DIN EN 983. Ultra High Flow valve for optimum flow and low pressure drop.

- Available on request:
  - with additional end connections

**Safety Note**

Reliable functioning can only be guaranteed in conjunction with original Parker Rectus plugs made of steel.

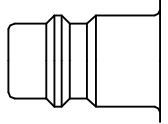

Euro Profile



**KE** Self-Venting System

**Working Pressure\*:**  
up to 12 bar

**Material:**

- Coupling: Nickel plated brass / steel
- Plug: Zinc plated steel
- Seals: NBR

**Working Temperature:**  
-20°C up to +100°C (NBR)

**Flow Rate Air:**  
2.020 l/min.  
inlet pressure 6 bar, pressure drop 0.5 bar

\* maximum static working pressure with design factor 4 to 1.

## Self-Venting System

### 1600KEAK Coupler with valve, Male Thread

Nickel-plated brass/steel, NBR

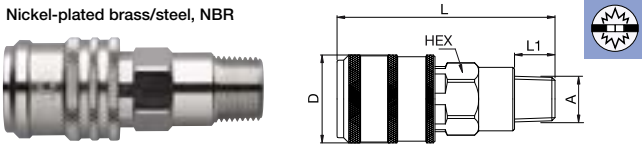

A	HEX	L	L1	D	
R1/4	1600KEAK13SPN	19	64.5	12	26
R3/8	1600KEAK17SPN	19	64.5	12	26
R1/2	1600KEAK21SPN	22	59	17	26

## Self-Venting System

### 1600KETF Coupler with valve, Hose Barb

Nickel-plated brass/steel, NBR

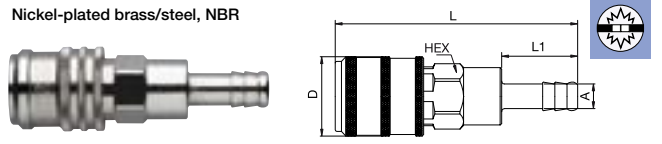

A	HEX	L	L1	D	
6	1600KETF06SPN	19	79.5	25	26
8	1600KETF08SPN	19	79.5	25	26
9	1600KETF09SPN	19	79.5	25	26
10	1600KETF10SPN	19	79.5	25	26
13	1600KETF13SPN	19	79.5	25	26

### 1600KEIW Coupler with valve, Female Thread

Nickel-plated brass/steel, NBR

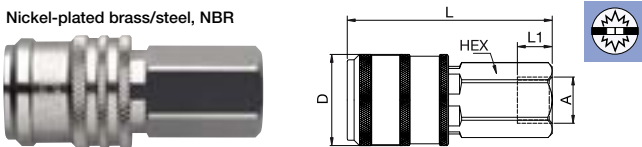

A	HEX	L	L1	D	
G1/4	1600KEIW13SPN	19	59	10	26
G3/8	1600KEIW17SPN	19	59	9	26
G1/2	1600KEIW21SPN	24	61.5	12	26

# Series 1600 - Self-Venting Sleeve Technology



## Self-Venting System

### 25SFAK Plug without valve, Male Thread

Zinc-plated steel

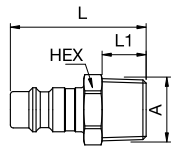

A		HEX	L	L1
R1/8	<b>25SFAK10SXZ</b>	13	33	9
R1/4	<b>25SFAK13SXZ</b>	14	37	12
R3/8	<b>25SFAK17SXZ</b>	17	37	12
R1/2	<b>25SFAK21SXZ</b>	22	43	17

### 25SFIW Plug without valve, Female Thread

Zinc-plated steel

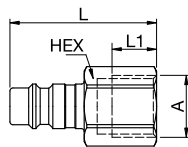

A			HEX	L	L1
G1/8	<b>25SFIW10SXZ</b>	<b>9086 25 10</b>	14	30	5
G1/4	<b>25SFIW13SXZ</b>	<b>9086 25 13</b>	17	38.5	12
G3/8	<b>25SFIW17SXZ</b>	<b>9086 25 17</b>	19	39.5	12
G1/2	<b>25SFIW21SXZ</b>	<b>9086 25 21</b>	24	44	14

### 25SFTF Plug without valve, Hose Barb

Zinc-plated steel

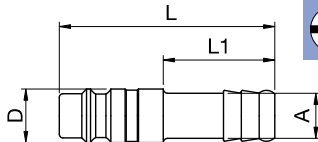

A			L	L1	D
6	<b>25SFTF06SXZ</b>	<b>9085 25 06</b>	48	25	12
8	<b>25SFTF08SXZ</b>	<b>9085 25 08</b>	48	25	12
9	<b>25SFTF09SXZ</b>	<b>9085 25 09</b>	48	25	12
10	<b>25SFTF10SXZ</b>	<b>9085 25 10</b>	48	25	12
13	<b>25SFTF13SXZ</b>	<b>9085 25 13</b>	48	25	15