

-10°C AIR VESSELS

**HORIZONTAL
PAINTED**

Material
Carbon steel

Fluid content
Compressed air / Nitrogen (group 2)

Finishing
External Ral 5015 blue paint (standard)

Upon request
1" couplings on heads

Directive	2014/29/UE	2014/68/UE(PED)
Operating pressure	11/16 bar	12/16 bar
Operating temperature	-10 +120°C	-10 +50°C

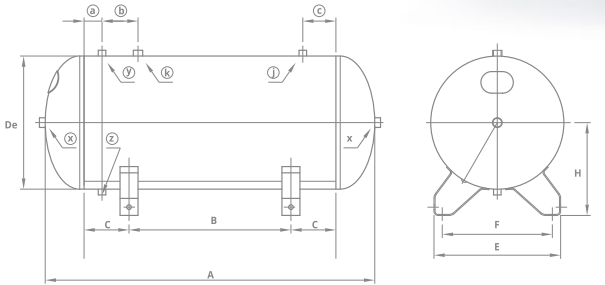
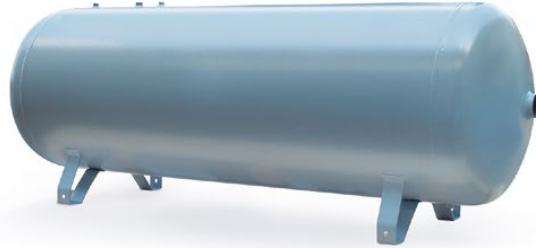

CODE	Directive	Capacity	Operating pressure	De	A	B	C	E	F	H	a	b	c	x	y	k	j	z	Weight	
		lt	bar	mm	mm	mm	mm	mm	mm	mm	mm	mm	mm	mm	mm	mm	mm	mm	mm	kg

RAL 5015*

VEC01095	2014/29/UE	100	11	370	1016	550	125	352	306	258	45	80	45	2"	3/8"	1/2"	3/8"	3/8"	29
VEC02139	2014/29/UE	150	11	396	1240	650	175	368	322	271	50	130	50	2"	3/8"	1/2"	3/8"	3/8"	44
VEC01732	2014/29/UE	200	11	446	1364	750	175	440	385	288	50	150	50	2"	3/8"	1/2"	3/8"	55	
VEC01733	2014/29/UE	270	11	500	1458	800	175	455	402	315	50	130	50	2"	3/8"	1"	1/2"	3/8"	67
VEC00728	2014/29/UE	500	11	600	1858	1204	148	530	470	396	60	155	60	2"	3/8"	1"	1/2"	3/8"	130
VEC00873	2014/29/UE	720	11	750	1850	970	215	570	460	495	60	155	60	2"	3/8"	1"	1/2"	3/8"	178
VEC00707	2014/29/UE	900	11	800	1960	1014	243	605	490	500	60	155	60	2"	3/4"	1"	1/2"	1/2"	194
VEC00515	2014/68/UE(PED)	1000	12	800	2158	1014	343	605	490	500	100	155	60	2"	3/4"	1"	1/2"	1/2"	210
VEC00739	2014/68/UE(PED)	1500	12	1000	2135	900	300	691	575	608	200	200	-	2"	1/2"	1/2"	-	1/2"	325
VEC00680	2014/68/UE(PED)	2000	12	1100	2252	1100	275	800	685	652	200	215	-	2"	1/2"	1/2"	-	1/2"	394
VEC00534	2014/68/UE(PED)	3000	12	1200	2850	1265	227	820	710	698	1230	200	-	2"	1/2"	1/2"	-	1/2"	605
VEC02257	2014/29/UE	270	16	500	1484	800	175	455	402	315	50	130	50	2"	3/8"	1"	1/2"	3/8"	104
VEC01113	2014/29/UE	500	16	600	1858	1204	148	530	470	396	60	155	60	2"	3/8"	1"	1/2"	3/8"	163
VEC00520	2014/68/UE(PED)	1000	16	800	2158	1014	343	605	490	500	100	155	60	2"	3/4"	1"	1/2"	1/2"	253
VEC00531	2014/68/UE(PED)	2000	16	1000	2570	1350	300	691	575	608	220	300	-	2"	1/2"	1/2"	-	1/2"	395
VEC02912	2014/68/UE(PED)	3000	16	1200	2850	1265	227	820	710	698	1230	200	-	2"	1/2"	1/2"	-	1/2"	640

-10°C AIR VESSELS

**HORIZONTAL
GALVANIZED - ALM**

Material
Carbon steel

Fluid content
Compressed air / Nitrogen (group 2)

Finishing
GALVANIZED: internal and external hot-dip galvanization
ALM: External Ral 5015 blue paint (standard) and Internal Ral 5005 ALM paint

Upon request
1" couplings on heads

Directive	2014/29/UE	2014/68/UE(PED)
Operating pressure	11/16 bar	12/16 bar
Operating temperature	-10 +120°C	-10 +50°C

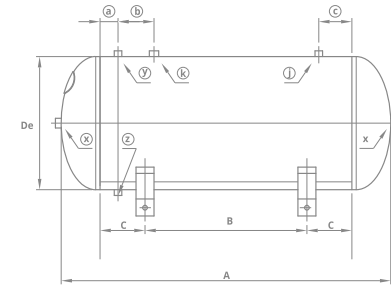
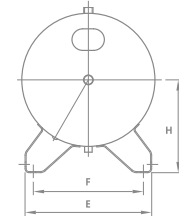

CODE	Directive	Capacity	Operating pressure	De	A	B	C	E	F	H	a	b	c	x	y	k	j	z	Weight	
		lt	bar	mm	mm	mm	mm	mm	mm	mm	mm	mm	mm	mm	mm	mm	mm	mm	mm	kg

GALVANIZED

VEC01735	2014/29/UE	270	11	500	1458	800	175	455	402	315	50	130	50	2"	3/8"	1"	1/2"	3/8"	70
VEC00874	2014/29/UE	500	11	600	1858	1204	148	530	470	396	60	155	60	2"	3/8"	1"	1/2"	3/8"	134
VEC02069	2014/29/UE	720	11	750	1850	970	215	570	460	495	60	155	60	2"	3/8"	1"	1/2"	3/8"	181
VEC02277	2014/68/UE(PED)	1000	12	800	2158	1014	343	605	490	500	100	155	60	2"	3/4"	1"	1/2"	1/2"	215
VEC00690	2014/68/UE(PED)	2000	12	1100	2252	1100	275	800	685	652	200	215	-	2"	1/2"	1/2"	-	1/2"	398
VEC02202	2014/68/UE(PED)	3000	12	1200	2850	1265	227	820	710	698	1230	200	-	2"	1/2"	1/2"	-	1/2"	609

ALM

VEC02317	2014/29/UE	270	11	500	1458	800	175	455	402	315	50	130	50	2"	3/8"	1"	1/2"	3/8"	67
VEC02127	2014/29/UE	500	11	600	1858	1204	148	530	470	396	60	155	60	2"	3/8"	1"	1/2"	3/8"	130
VEC02202	2014/29/UE	720	11	750	1850	970	215	570	460	495	60	155	60	2"	3/8"	1"	1/2"	3/8"	178
VEC02285	2014/68/UE(PED)	1000	12	800	2158	1014	343	605	490	500	100	155	60	2"	3/4"	1"	1/2"	1/2"	210
VEC02100	2014/68/UE(PED)	2000	12	1100	2252	1100	275	800	685	652	200	215	-	2"	1/2"	1/2"	-	1/2"	394
VEC02284	2014/68/UE(PED)	3000	12	1200	2850	1265	227	820	710	698	1230	200	-	2"	1/2"	1/2"	-	1/2"	605